



EAE

EE-C10

MANUAL RELEASE TWO POST LIFT



4.5T
10000LBS.
Lifting Capacity

95MM
3 3/4"
Min. Height

1800MM
70 7/8"
Max. Lifting Height

EE-C10 MANUAL RELEASE TWO POST LIFT

Main Features



- 4500kg(10000LBS.) lifting capacity.
- 1900mm(74 3/4") Max. lifting height with standard SUV adapters.
- Single side release for mechanical safety locking unit.
- Cylinder straight top device, run more smoothly.
- Clear floor design for easy movement of maintenance equipment under the raised vehicle.
- Durable cylinders in each column carry with anti-surge valves.
- Screw-up lifting pads with clearance height less than 95mm(3 3/4").

Overall Dimension & Technical Data

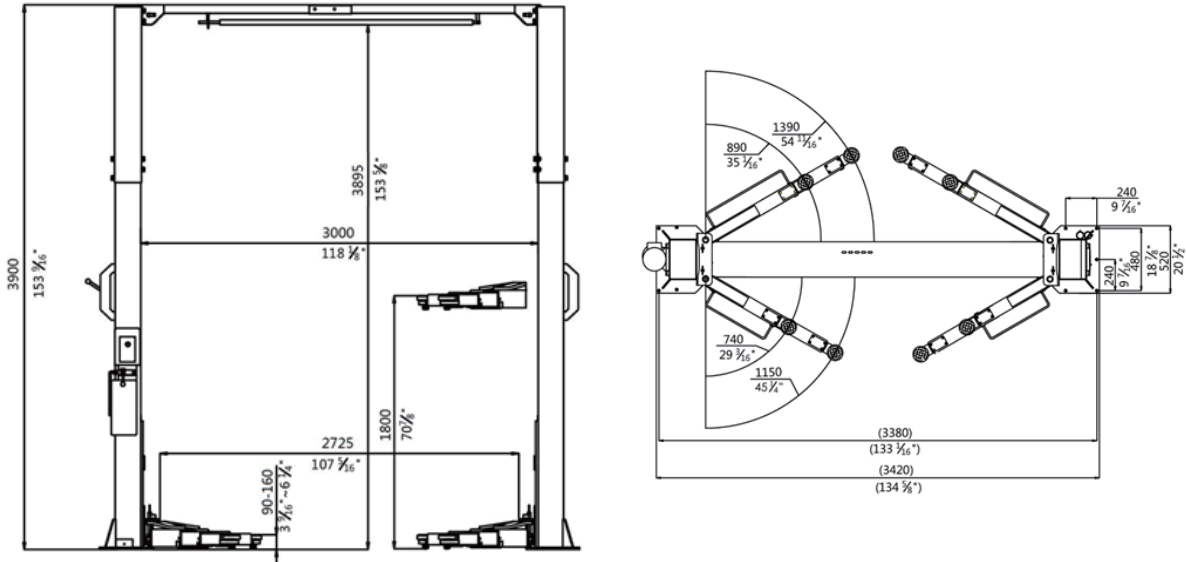

MODEL NO.	EE-C10
Lifting capacity	4500KG(10000LBS)
Column height	3900mm(153 9/16")
Max lifting height	1800mm(70 7/8")
Max lifting height with standard SUV adapters	1900mm(74 3/4")
Min height	95mm(3 3/4")
Lifting time	55S
Capacity of motor	2.2KW
Rated oil pressure	18Mpa
Drive through	2725mm(107 5/16")
Weight	644KG(1420LBS)
Electricity supply	According To Customer Needs

*Lifting height is measured with adjustable screw pads in highest position.
Machine shown with optional equipment. Actual product appearance may differ.

Detail display



One Side Safety Locks Release



Pulley with Derailment Protection



Door Protection Pads



Height Adapter



Round Screw-up Lifting Pad

EAE Automotive Equipment Company Limited

www.eae-ae.com Toll Free Call:400 9911 109 sales@eae-ae.com

